

### ASSEMBLY DIAGRAM

Asahi A92, B92, C92, S92 Actuators

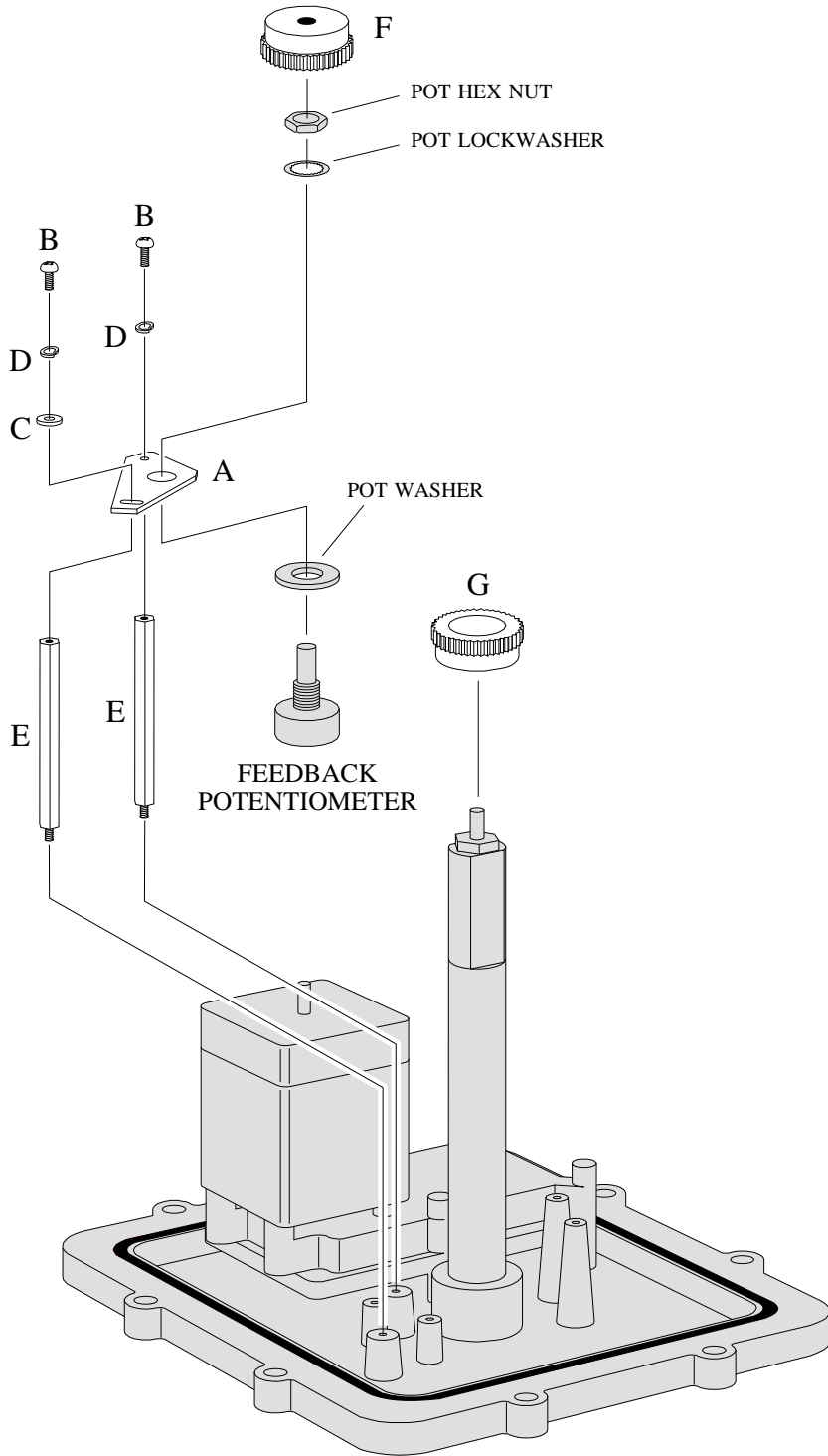

ACTUATOR

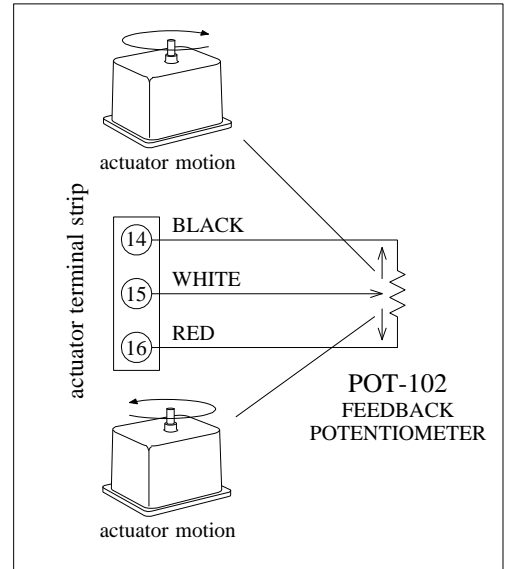

ELECTRICAL DIAGRAM

## KIT CONTENTS

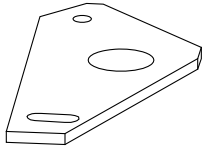

A

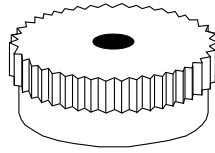

F

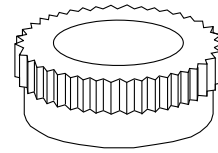

G



B



C



D



E

ITEM	QTY	DESCRIPTION
A	1	potentiometer bracket
B	2	#4-40 x 0.25" pan head screw
C	1	#4 flat washer
D	2	#4 split ring lockwasher
E	2	2.25" male/female hex spacer
F	1	potentiometer gear
G	1	output shaft gear

# AC to DC MODULE

## WIRING DIAGRAM

Asahi A92, B92, C92, S92 Actuators

The ADM-100A AC to DC Module allows a 24VDC actuator to be controlled like a 24VAC split-phase motor actuator.

