

ASSEMBLY DIAGRAM

HKC HQ-015, -020, -030, -050, -060, -080, -120, -200, -300 Actuators

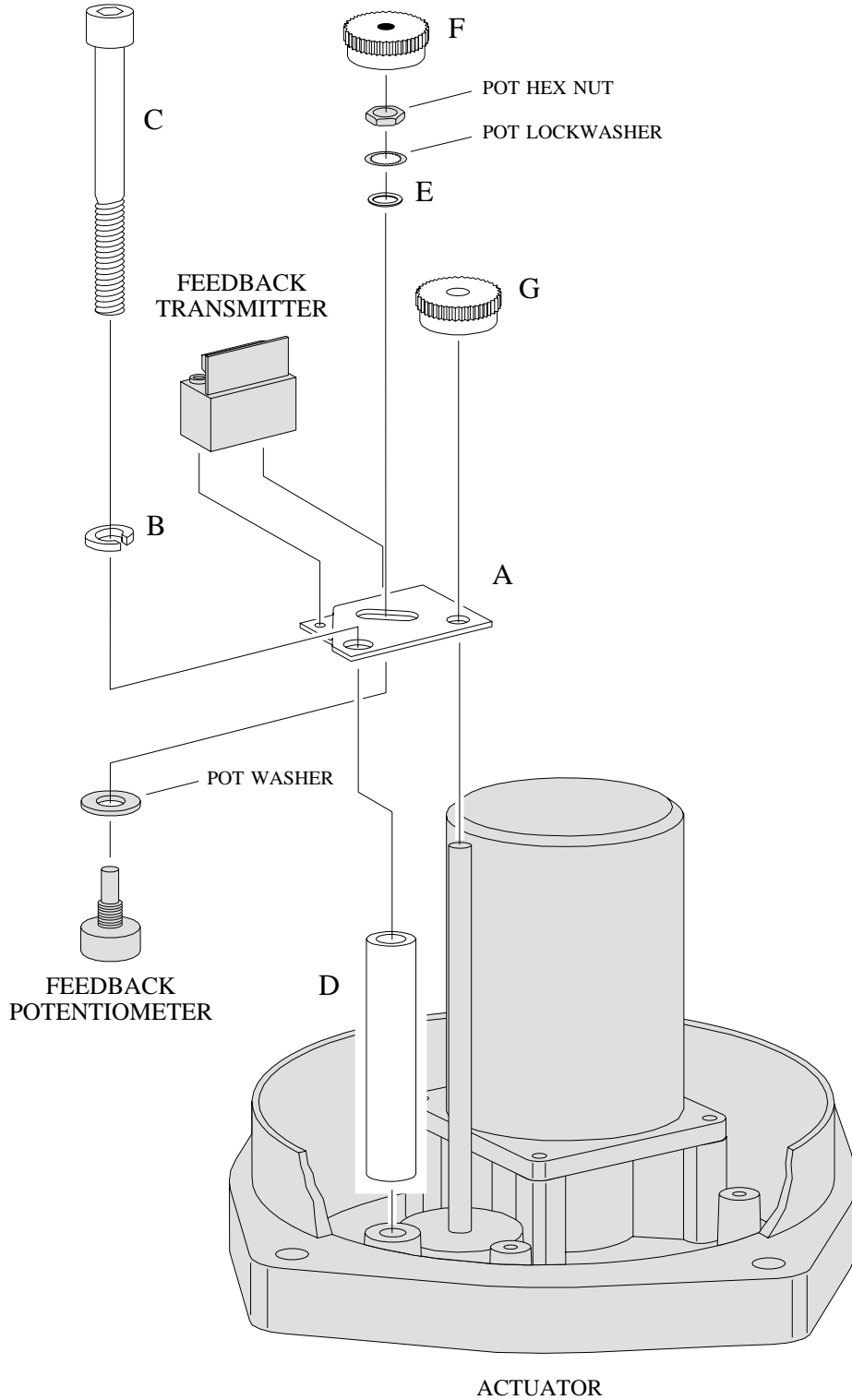

KIT CONTENTS

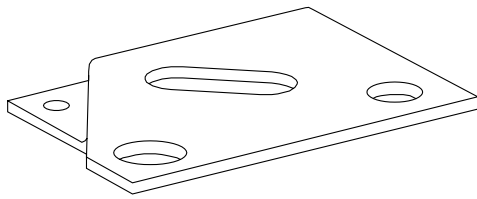

A

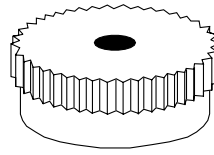

F

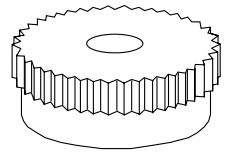

G



B

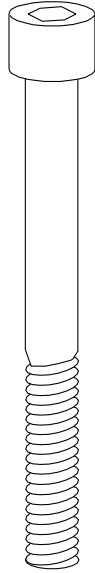

C

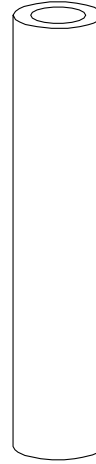

D



E

ITEM	QTY	DESCRIPTION
A	1	potentiometer bracket
B	1	10mm split ring lockwasher
C	1	10mm/1.5mm X 90mm socket head cap screw
D	1	3.1" round spacer
E	1	potentiometer anti-slip washer
F	1	potentiometer gear
G	1	output shaft gear

FEEDBACK TRANSMITTERS (externally powered)

WIRING DIAGRAM

HKC HQ-015, -020, -030, -050, -060, -080, -120, -200, -300 Actuators

NOTE: Items shown in brackets [] pertain to HQ-200 and HQ-300 actuators only.

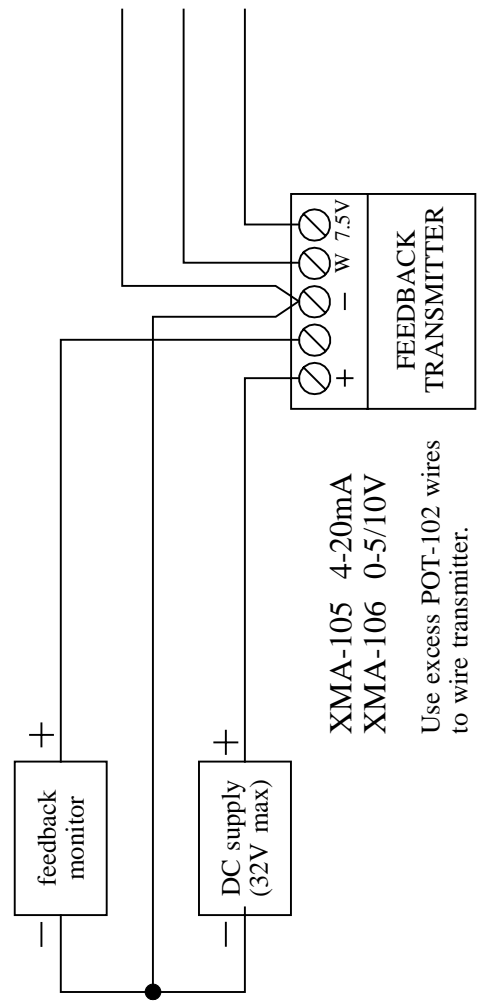
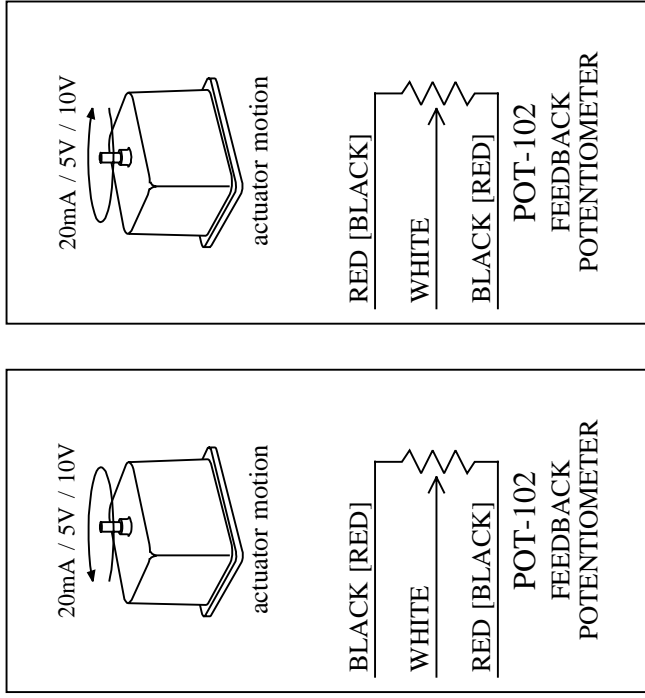

FEEDBACK TRANSMITTER (loop powered)

WIRING DIAGRAM

HKC HQ-015, -020, -030, -050, -060, -080, -120, -200, -300 Actuators

NOTE: Items shown in brackets [] pertain to HQ-200 and HQ-300 actuators only.

